

TYPHOON METAL CEILING FAN



Antique Brass

Installation Locations:

Indoor Only

Recommended Height:

There should be at least 2.1m between the lowest point of the fan blades and the floor.

Top of canopy cover to lowest point of the fan:

Approximately 35cm

Motor:

16 Pole, 188mm x 15mm motor (48" & 52")
 16 Pole, 188 x 25mm Motor (56")
 Made with the highest grade copper windings and silicone steel stator. Bearings are sealed to ensure quiet operation and long life.

Motor Housing:

Materials: Pressed Steel (Painted, Plated or Powder Coated Finish)

Available Colours :

White, White Birch, Matt Black, Brushed Chrome, Antique Brass & Burnt Copper

Blades:

Sizes: 1220mm (48") 1320mm (52") 1400mm (56")
 Materials: Steel
 Blade Pitch: 22°

Available Blade Colours:

White, White Birch, Matt Black, Brushed Silver, Antique Brass & Burnt Copper

Extra Information:

Introduced into the HPI range in 2004
 3 Speed wall controller
 Light Adaptable
 Reversible

Standard Canopy Cover:

Suitable for flat and pitched ceilings up to 28°

Wall Controller Speed Capacitor Values:

3.5µF & 1.7µF (48" & 52") 4.3µF & 2.1µF (56")

Rotational Diameter:

1220mm (48") 1320mm (52") 1400mm (56") Blade Sweep

Weight Including Packaging:

Complete fan 1220mm(48") : 7.1kg
 Complete fan 1320mm(52") : 8.4kg
 Complete fan 1420mm(56") : 8.7kg

Packaging Dimensions (cm):

Complete fan 1220mm (48"): 62L x 22W x 27H
 Complete fan 1320mm (52"): 62L x 22W x 27H
 Complete fan 1400mm (56"): 68L x 22W x 27H

Accessories:

Remote Control
 Extension Down Rod 21mm diameter
 45° Ceiling Kit (for pitched ceilings)
 T-Hook for ceiling roses
 Universal Mounting Brace

Warranty

2 years "in home" covering major defects
 3 Years additional covering motor only (not labour)
 Remotes -1 year "in home" covering major defects.
 (receiver and handpiece)
 Lights -1 year "in home" covering major defects

Airflow and Efficiency:

Airflow measured in Australia using the "Energy Star Solid-State Test Method", the only test method recognised for USA Energy Star compliance.

<i>Figures shown are tested on 52" Fan</i>	HIGH	MED	LOW
RPMS	249	165	79
WATTS	70.7	34	10.7
AIRFLOW[^]: AUS-ES / USA-ES	12574 / 16974	8289 / 11190	3705 / 5002
EFFICIENCY[^]: AUS-ES / USA-ES	177.85 / 240.08	243.79 / 329.12	346.26 / 467.45

[^] Airflow measured in Cubic metres/ Hour (CM/HR), Efficiency measured in CM/HR per watt (CMH/W)

For full warranty details please see Hunter Pacific International's website www.hunterpacific.com.au

TYPHOON RANGE CEILING FAN LIGHTING



78mm Halogen Light (MAX 100W)

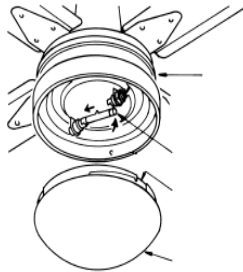

- Cost effective
- Colour—warm white
- Dimmable
- Compact in size

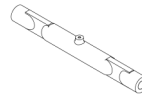

78mm linear Halogen Light globe

GLACIER STYLE GLASS



ECLIPSE STYLE GLASS



E27 Light (MAX 2x40W)

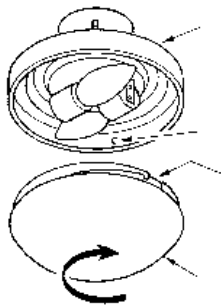

- Accepts a variety of lamps, e.g. incandescent, fluorescent.
- Cost effective
- Compatible with some CFL lamps



E27

Colours Available:

All light kits are available in most motor colours ~ White, White Birch, Black, Brushed Chrome, Polished Brass, Antique Brass, Burnt Copper and Stainless Steel.

Packaging Dimensions

17H x 25W x 25L

Weight

1.5 kg

GX53M 14W Compact Fluorescent Light

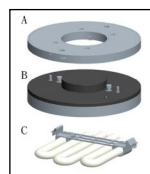
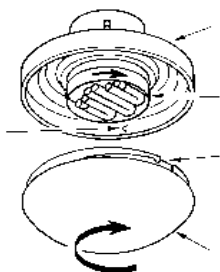

- A Base
- B Lamp Assembly
- C Tube

- Low wattage
- High light output
- Liquid mercury free
- Colour—Warm white/Cool white colour temperatures available
- Low heat
- 12000 hour life span
- 2700k or 3000k

^ All light kits must be installed by a licensed electrician. For further information about correct installation procedures, please see www.hunterpacific.com.au

For full warranty details please see Hunter Pacific International's website www.hunterpacific.com.au