

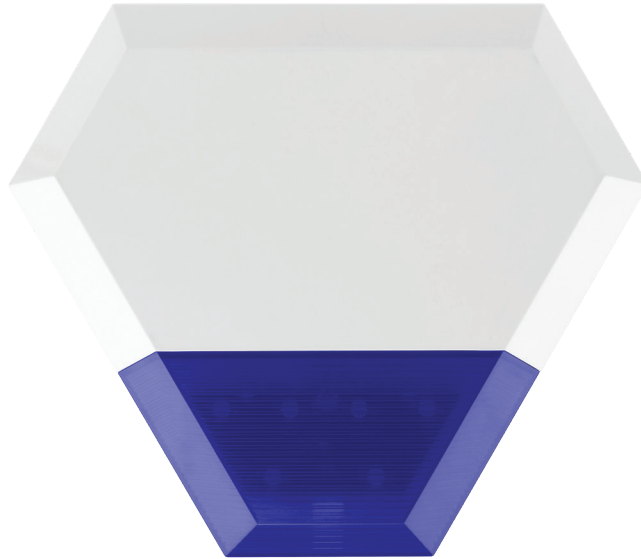

OUTDOOR STROBE SIREN

INTWS901



The Siren is a new generation of professional high power acoustic siren with battery back-up and flashlight.

The Siren has a tough, weatherproof housing that is IP56-rated. The inbuilt LED indicator unit acts as a visible deterrent and provides visual indication that the system is active. The LEDs will alternately flash while the system is being Armed or Disarmed. When an alarm occurs, the LEDs will flash rapidly in unison. The tamper switch will trigger an alarm if any attempt is made to remove or interfere with the Siren after installation.

KEY FEATURES

- Tamper protection
- High powered siren & flashing strobe lens
- Wireless transmission. Easy to install
- Selectable Siren volume & duration
- Automatic switching between DC & AC ensures uninterrupted power supply

FIRE • SECURITY • INTERCOMS



SPECIFICATIONS

Model	INTWS901	
Outdoor Siren Strobe Specifications	Power Supply:	DC 12V
	Solar Power Supply	6V 1A (optional)
	Standby Current	<20mA
	Max Alarm Current	<350mA
	Battery Backup	3.7V/2200mA Lithium battery
	Standby Current:	<12mA
	Wireless Receiving Distance	80m (Open area)
	Radio Frequency	433MHz FHSS
	Max Siren Volume	115dB
	Operating Temperature	-25°C+55°C
	Operating Humidity	≤ 95%(non-condensing)
	Housing Material	ABS
Measurement (LxHxW)	288x250x56.5 mm	

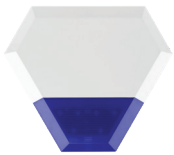

PCB BOARD DIAGRAM

1. Built-in battery
2. Arm/Disarm promptn/off
3. Siren volume selection
4. Siren duration selection
5. On/Off switch
6. Enrol button
7. Status LED
8. Status/Alarm strobe lens
9. Alarm LED
10. Built-in siren
11. Anti-tamper switch
12. Adapter interface

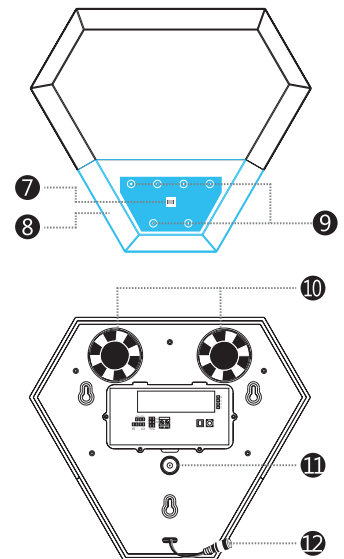
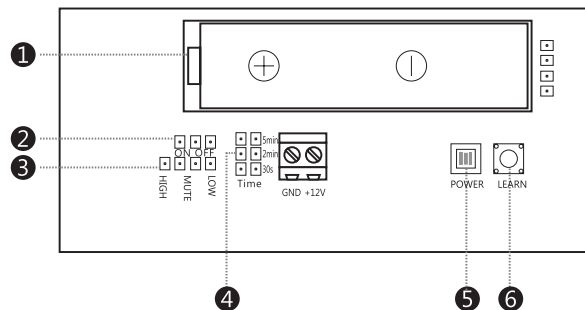

FIRE • SECURITY • INTERCOMS