

PHOTOELECTRIC SMOKE ALARM



9V Battery



20 - 40 m²
Coverage



MODEL: R9

Key Information

| | |
|----------------------|---|
| Product or component | Smoke Alarm |
| Device application | Early Detection of Smouldering Fires and Open Fires |
| Sensor type | Photoelectric Sensor |
| Colour | White |
| Quantity | Set of 1 |
| Packaging type | Carton |

| | |
|---------------------------------------|---|
| Power Supply | DC Battery |
| Battery Type | 9V Carbon Zinc Battery |
| Battery Life | 1 YR |
| Operating Current | 10 µA |
| Detection Type | Smoke |
| Function | Hush Function Smoke Detection Local Alarm |
| Control Type | Button for Test / Hush Function |
| Response Time | Approx. 8 SEC |
| Noise Level | 85 dB at 3M Minimum |
| Time Delay Range | 10 MIN: for Hush 10 HR: for Silence |
| Local Signal | Sound: Alarm Sound: Signal Visual: 1 LED (Red) for Warning, Low Battery |
| Type of Installation | Indoor |
| Device Mounting | Surface |
| Fixing Type | By Screws |
| Alarm Diameter | 100 MM |
| Protrusion from Ceiling | 34 MM |
| Ambient Air Temperature for Operation | 0...40°C |
| Relative Humidity | 10...90% |
| Product Certifications | CSIRO |
| Standards | AS 3786:2014+A1:2015+A2:2018 |

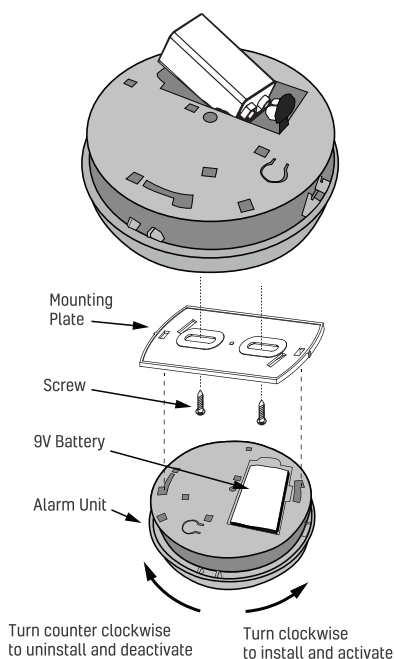

Scan QR code to find out all the compatible alarms and installation

The information provided in this documentation contains general descriptions and/or technical characteristics of the performance of the products contained herein. This documentation is not intended as a substitute for and is not to be used for determining suitability of reliability of these products for specific user applications. It is the duty of any such user or integrator to perform the appropriate and complete risk analysis, evaluation and testing of the products with respect to the relevant specific application or use thereof. Neither Red Smoke Alarms PTY. LTD nor any of its affiliates or subsidiaries shall be responsible or liable for misuse of the information contained herein.