

LED Diffused Batten

Product Range

Cat No.	Configuration
TPDB600	Diffused Batten, 600mm
TPDB1200	Diffused Batten, 1200mm

1 Package contents

- A Diffused Batten, 600mm/1200mm
- B Accessories
- C Installation guide

2 Dimensions

3 Wiring diagram

Red: Line/Active

4 Mounting and installation

⚠ ⚠ DANGER

HAZARD OF ELECTRIC SHOCK

- This product must be installed and serviced by appropriately qualified and/or licenced electrical personnel.
- Isolate the electrical supply before doing any work on this product.
- Ensure that the product has been correctly installed and tested for safe operation before reconnecting the electrical supply.
- To comply with all safety standards, the product must be used only for the purpose described in this instruction and must be installed in accordance with the wiring rules and regulations in the location where it is installed.

Failure to follow these instructions will result in death or serious injury.

⚠ CAUTION

RISK OF EQUIPMENT DAMAGE

The light source contained in this luminaire shall only be replaced by the manufacturer or a service agent or a similar qualified person.

Failure to follow these instructions can result in minor injuries or equipment damage.

⚠ CAUTION

RISK OF BURN INJURIES

During and after use, the product may be hot. Do not touch the product before it has completely cooled down.

Failure to follow these instructions can result in minor injuries or equipment damage.

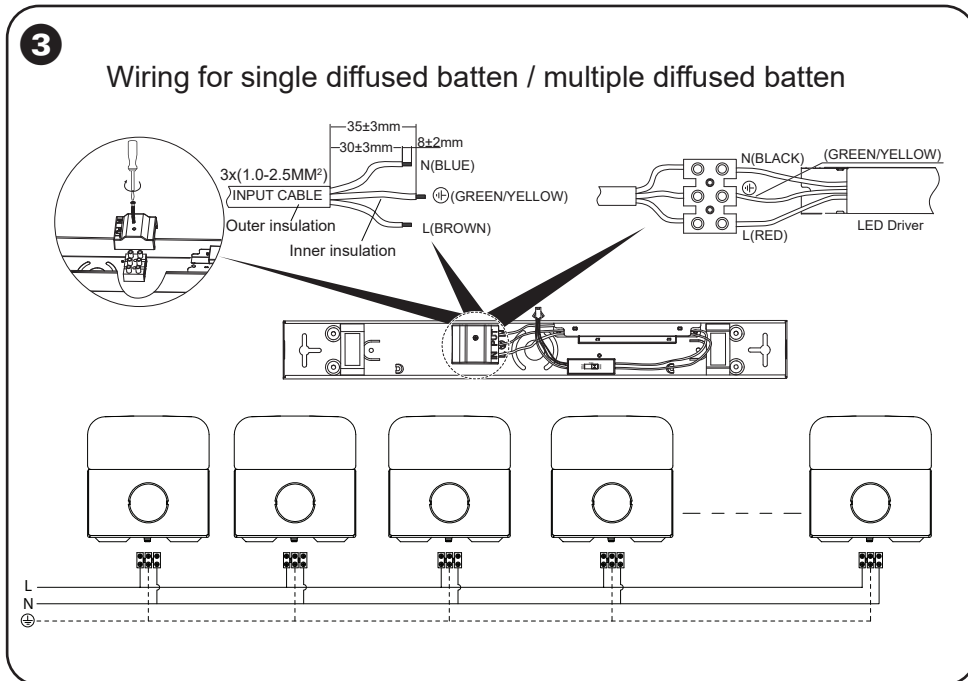
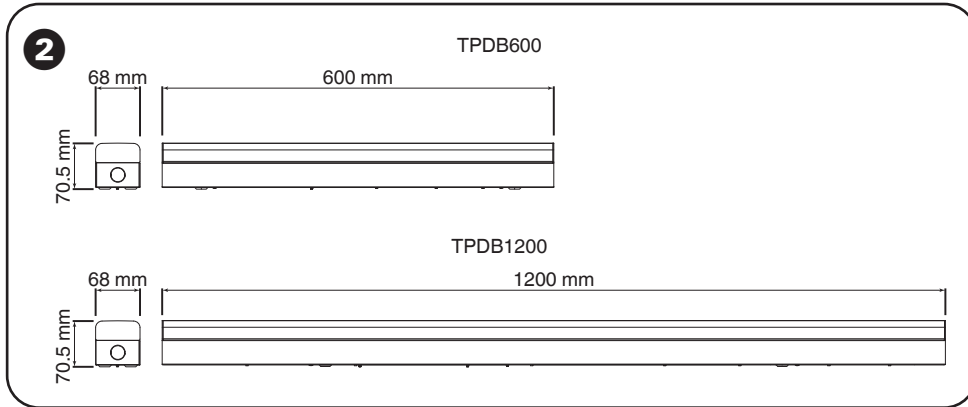
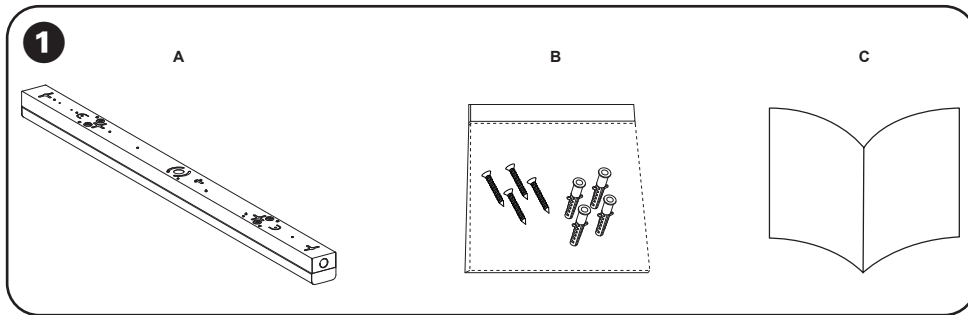

Installation requirements

- Check whether the product has been damaged during transport. Do not operate/install any product which appears damaged in any way. Return the complete batten to place of purchase for inspection, repair or replacement.
- Take care not to pull any electrical wires during unpacking, as this may damage the connection.
- Isolate the electrical supply before commencing any installation.
- There are no user serviceable parts inside.

a. Pre-Installation

Colour Temperature Selector

These Diffused Battens have a Tri-Temp colour selector switch allowing the options of 3 different light temperature outputs. Select the desired position prior to installation. The switch is located on the bottom side of the batten assembly.

b. Surface Mounted Installation Instruction

NOTE: Make sure colour temperature is selected prior to installation.

- (1) Disconnect the Mains supply before installation or removing cover.
- (2) Pull LED strip apart from batten base.
- (3) Unscrew the junction box with a screwdriver.
- (4) Fix the batten base onto the required place with appropriate screws.

4

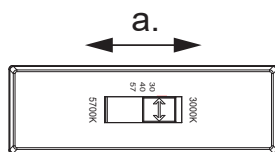

3000K	4000K	5700K
Warm White	Cool White	Daylight

b.

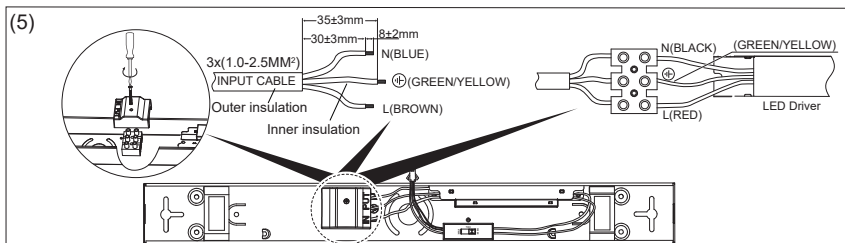
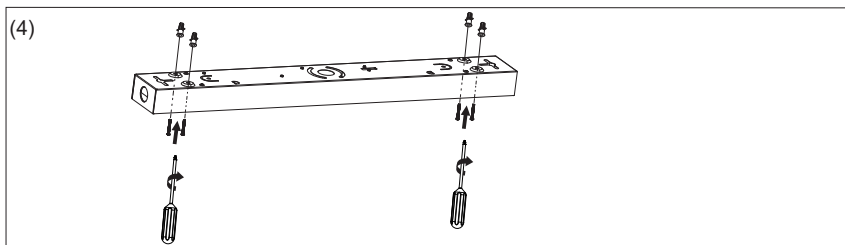
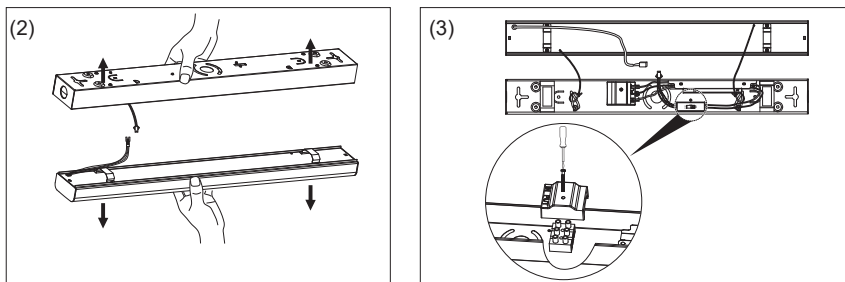

2 methods to insert Power cord wiring

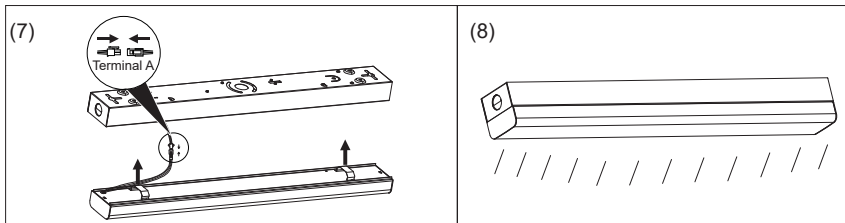
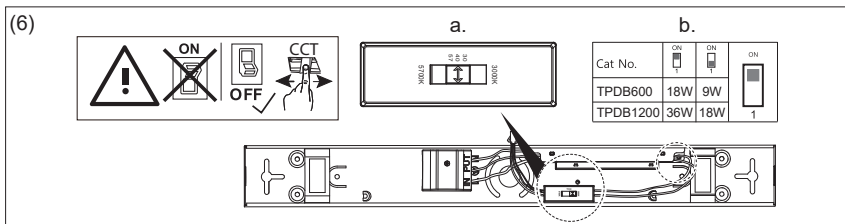
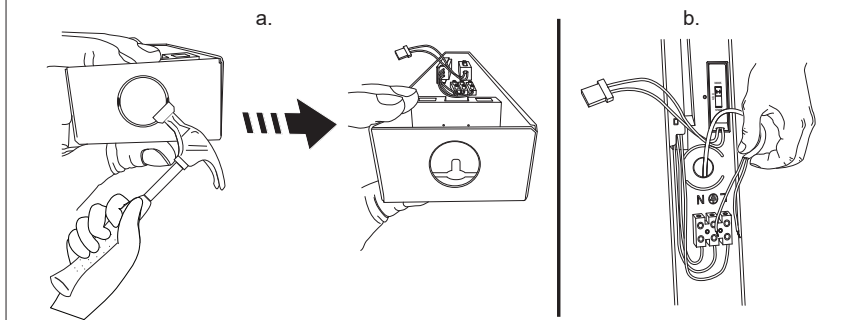

(5) Connect the live wire, neutral wire, and earth wire separately to the corresponding positions of the terminal block as shown on the base, then close the junction box.

a. Knock off the seals on both sides of the batten using the hammer, and insert an external power cord cable.

b. Insert the external power cord cable through the batten bottom hole.

(6) Setting the temperature and power switch:

a. To set the colour temperature, move the dip switch located at the back of the batten base to the desired colour temperature. Fasten terminal A between driver and LED module. Snap LED module back to the batten base.

b. To set the power switch, push the power switch to the ON position for high wattage and to position 1 for low wattage.

IMPORTANT: The default setting for the power switch is in the ON position, with a higher wattage, and the color temperature is set to 4000K.

(7) Push the LED strip back to batten base until it is secured on it.

(8) Reconnect mains supply.

Technical data

Cat No.	TPDB600	TPDB1200
Voltage Rating	230 - 240 V~, 50 Hz	
LED Power	9 W/18 W	18 W/36 W
Current	55 mA for 9 W 110 mA for 18 W	110 mA for 18 W 220 mA for 36 W
Lumens	1125 lm for 9 W 2250 lm for 18 W	2250 lm for 18 W 4500 lm for 36 W
Colour Temp	Selectable 3000K / 4000K / 5700K	
CRI	> 80	
IP Rating	IP20	
LED Lamp Life (L70)	50,000 Hrs	
Dimensions mm (LxWxH)	600x68x70.5	1200x68x70.5
Operating Temp	-10 °C to 45 °C	
Operating Humidity	10% to 95% RH non condensing	
Weight	~0.9 kg	~1.52 kg
Class	I	

Warranty information (Australia)

We warrant this product for 5 years—visit <https://www.schneider-electric.com.au/en/aboutus/legal/terms-and-conditions.jsp>
Our goods also come with guarantees that cannot be excluded under the Australian Consumer Law. You are entitled to a replacement or refund for a major failure and compensation for any other reasonably foreseeable loss or damage. You are also entitled to have the goods repaired or replaced if the goods fail to be of acceptable quality and the failure does not amount to a major failure.

Schneider Electric (Australia) Pty Ltd
33-37 Port Wakefield Road, Gepps Cross, SA 5094
Customer Care: 13 73 28
Email: customer-care.au@se.com
www.clipsal.com

Warranty information (New Zealand)

We warrant this product for 5 years—visit <https://www.schneider-electric.co.nz/en/aboutus/legal/terms-and-conditions.jsp>

Schneider Electric (NZ) Ltd
Building 6, 60 Highbrook Drive, East Tamaki, 2013, New Zealand
Customer Care: 0800 741 303
Email: customer-care.nz@se.com
www.pdl.co.nz

Schneider Electric reserves the right to change specifications, modify designs and discontinue items without incurring obligation and whilst every effort is made to ensure that descriptions, specifications and other information in this instruction is correct, no warranty is given in respect thereof and the company shall not be liable for any error therein. © Schneider Electric 2024. This material is copyright under Australian, New Zealand and international laws. Except as permitted under the relevant law, no part of this work may be reproduced by any process without prior written permission of and acknowledgement to Schneider Electric.