

TPBH



1

A

B

C

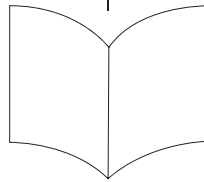
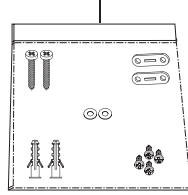
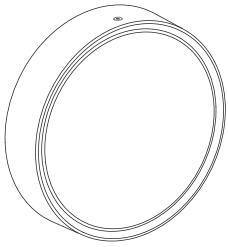

2

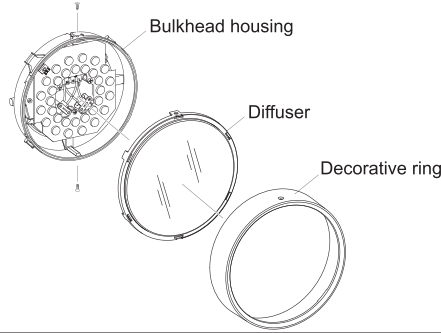
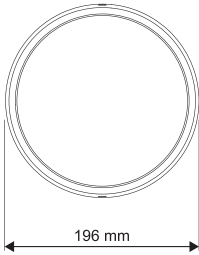

3

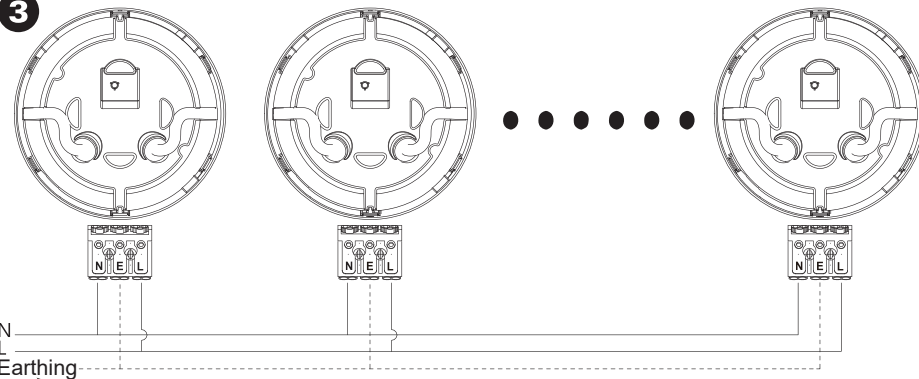

N  
Earth

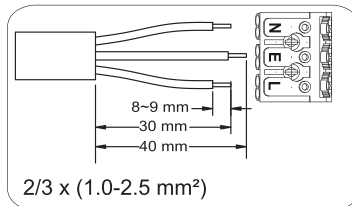
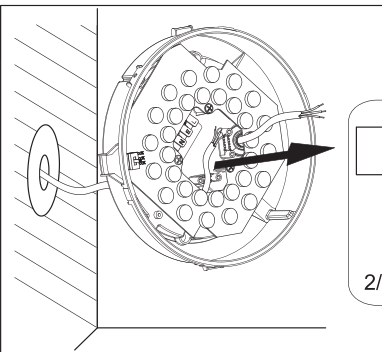

## Exterior Bulkhead

### Product Range

Cat No.	Configuration
TPBH	Exterior Bulkhead

### 1 Package contents

- A Exterior Bulkhead
- B Accessories
- C Installation guide

### 2 Dimension

### 3 Wiring diagram

### 4 Mounting and installation

#### ⚠ ⚠ DANGER

##### HAZARD OF ELECTRIC SHOCK

- This product must be installed and serviced by appropriately qualified and/or licensed electrical personnel.
- Isolate the electrical supply before doing any work on this product.
- Ensure that the product has been correctly installed and tested for safe operation before reconnecting the electrical supply.
- To comply with all safety standards, the product must be used only for the purpose described in this instruction and must be installed in accordance with the wiring rules and regulations in the location where it is installed.

**Failure to follow these instructions will result in death or serious injury.**

#### ⚠ CAUTION

##### RISK OF EQUIPMENT DAMAGE

The light source contained in this luminaire shall only be replaced by the manufacturer or a service agent or a similar qualified person.

**Failure to follow these instructions can result in minor injuries or equipment damage.**

#### ⚠ CAUTION

##### RISK OF BURN INJURIES

During and after use, the product may be hot. Do not touch the product before it has completely cooled down.

**Failure to follow these instructions can result in minor injuries or equipment damage.**

### Important

- Check whether the product has been damaged during transport. Do not operate/install any product which appears damaged in any way. Return the complete bulkhead to place of purchase for inspection, repair or replacement.
- Take care not to pull any electrical wires during unpacking, as this may damage the connection.
- A maximum of 20 devices can be wired in series to reduce large inrush current and/ or nuisance tripping.

### Mounting and installation instruction

- (1) Turn off the mains power supply before installation or removing the cover.
- (2) Remove the screws using a screwdriver to detach the housing from the bulkhead assembly.
- (3) Dismantle the diffuser by pushing out all the clamps from the bulkhead housing.
- (4) Pierce the flexible gasket before inserting wires into the bulkhead.
  - a. Secure the clamps onto the wiring cable inside the bulkhead housing using the provided screws.
  - b. Install the wires according to the wiring diagram illustrated 3.
- (5) Use the switch to select the required color temperature.
 

**NOTE:** By default the switch is set to 3000K color temperature.
- (6) Mount the bulkhead housing on the wall using the wall plug and the screws.
- (7) Using the provided screws, fix the diffuser and the decorative ring on top of the bulkhead housing.
- (8) Turn on the mains power supply.

4

(1)

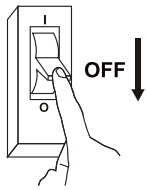

(2)

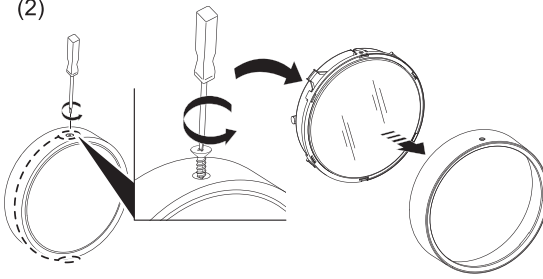

(3)

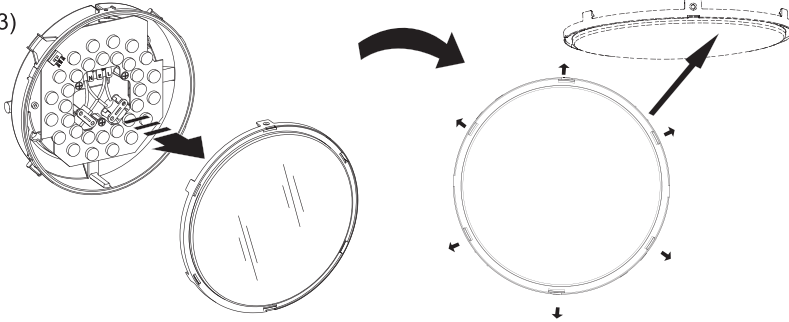

(4)

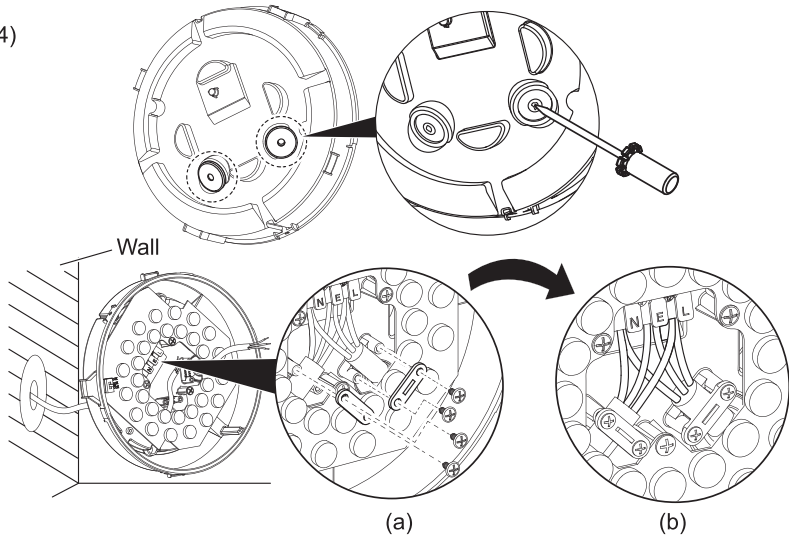

(5)

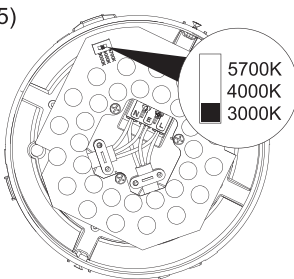

(6)

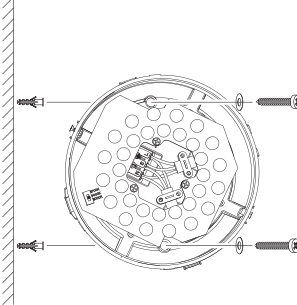

(7)

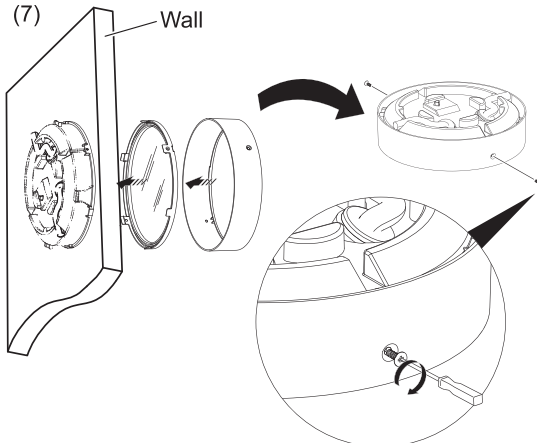

(8)

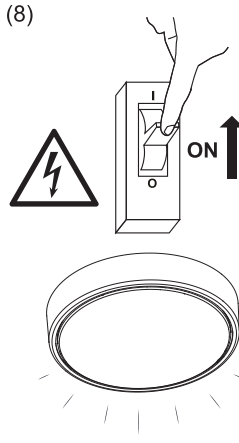

## Technical data

Cat No.	TPBH
Voltage Rating	230 - 240Vac, 50Hz
IP Rating	IP54
IK Rating	IK08
Total Power Consumption	9W
Beam Angle	120°
Lumen Output	600lm
Operating Temperature	-10°C to +45°C
Operating Humidity	10% to 95%, RH, no condensing
CRI	>80
Colour Temperature	3000K/4000K/ 5700K (Selectable)
Current	90mA
Inrush Current	6A @ 20 µs
Dimension L × H × W	196mm × 58mm × 196mm
Lifespan L70/B50 @25°C	50,000 hours
Material	Housing/PC Decorative Ring/Aluminium
Dimmable	No
Class	Class II
Warranty	5 Years

## Warranty Information

We warrant this product for 5 years—visit

<https://www.schneider-electric.com.au/en/about-us/legal/terms-and-conditions.jsp> for details.

Our goods also come with guarantees that cannot be excluded under the Australian Consumer Law. You are entitled to a replacement or refund for a major failure and compensation for any other reasonably foreseeable loss or damage. You are also entitled to have the goods repaired or replaced if the goods fail to be of acceptable quality and the failure does not amount to a major failure.

## Schneider Electric (Australia) Pty Ltd

Customer Care: 13 73 28

33-37 Port Wakefield Road, Gepps Cross SA 5094

Email: [customer-care.au@schneider-electric.com](mailto:customer-care.au@schneider-electric.com)

[www.schneider-electric.com.au](http://www.schneider-electric.com.au)

Schneider Electric reserves the right to change specifications, modify designs and discontinue items without incurring obligation and whilst every effort is made to ensure that descriptions, specifications and other information in this instruction is correct, no warranty is given in respect thereof and the company shall not be liable for any error therein.

© Schneider Electric 2025

This material is copyright under Australian, New Zealand and international laws. Except as permitted under the relevant law, no part of this work may be reproduced by any process without prior written permission of and acknowledgement to Schneider Electric.