

TPSF



## Spot Light Twin with Sensor

### Product Range

| Cat No. | Configuration               |
|---------|-----------------------------|
| TPSF    | Spot Light Twin with Sensor |

### 1 Package contents

- A Spot Light Twin with Sensor
- B Accessories
- C Installation guide

### 2 Dimension

### 3 Wiring diagram

### 4 Mounting and installation

#### ⚠ DANGER

##### HAZARD OF ELECTRIC SHOCK

- This product must be installed and serviced by appropriately qualified and/or licensed electrical personnel.
- Isolate the electrical supply before doing any work on this product.
- Ensure that the product has been correctly installed and tested for safe operation before reconnecting the electrical supply.
- To comply with all safety standards, the product must be used only for the purpose described in this instruction and must be installed in accordance with the wiring rules and regulations in the location where it is installed.

**Failure to follow these instructions will result in death or serious injury.**

#### ⚠ CAUTION

##### RISK OF BURN INJURIES

During and after use, the product may be hot. Do not touch the product before it has completely cooled down.

**Failure to follow these instructions can result in minor injuries or equipment damage.**

#### ⚠ WARNING

##### SERIOUS EYE INJURY

- Do not operate with wet hands, and never look directly into the LED light source while it's lighting to avoid damage to the eyes.
- The light source of this luminaire is not replaceable; when the light source reaches its end of life the whole luminaire shall be replaced.
- Beware of glass fragments as this luminaire may be installed higher than 5m.

**Failure to follow these instructions can result in death, serious injury, or equipment damage.**

### Installation requirements

- Check whether the product has been damaged during transport. Do not operate/install any product which appears damaged in any way. Return the complete spotlight to place of purchase for inspection, repair or replacement.
- Take care not to pull any electrical wires during unpacking, as this may damage the connection.
- Isolate the electrical supply before commencing any installation.
- There are no user serviceable parts inside.

### (1) Installation Instruction

**NOTE:** Rotate the twin spotlight 90° by unscrewing the adjuster screw provided on the side of the spotlight and then insert the screwdriver into the designated screw slot.

- a. Remove the screws using a screw driver.
- b. Dismantle the back cover from the housing.

1

A

B

C

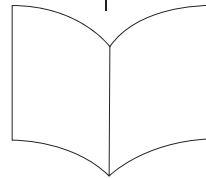
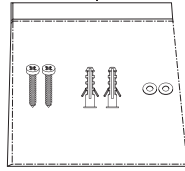
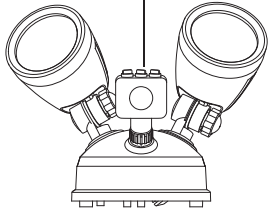

2

Front View

Top View

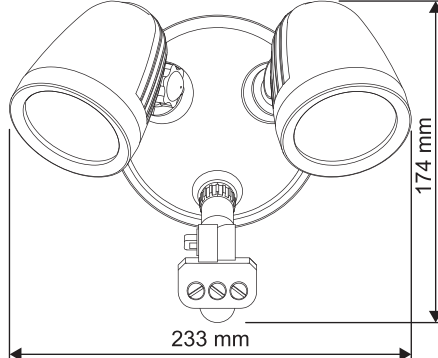
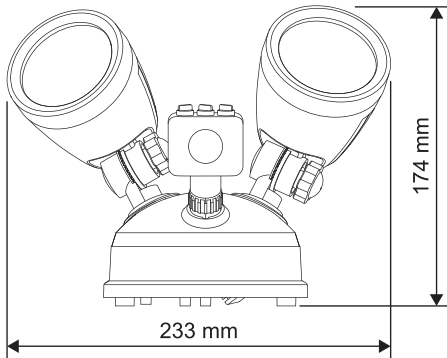

3

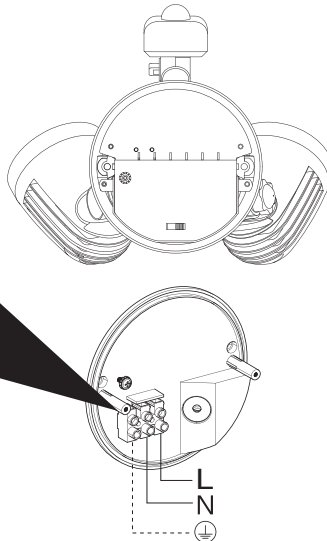
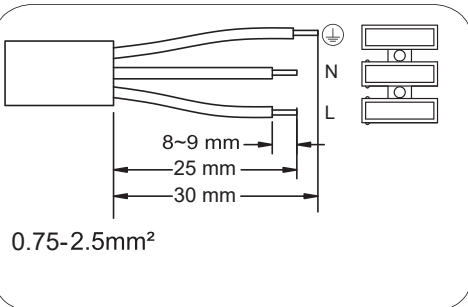

4

(1)

a.

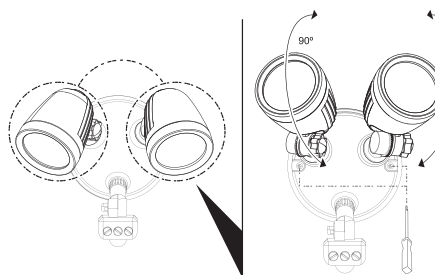

(1)

b.

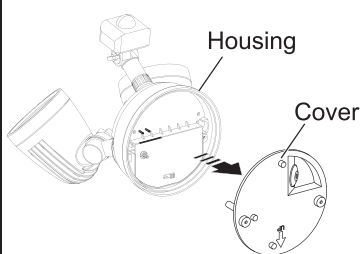

(1)

c.

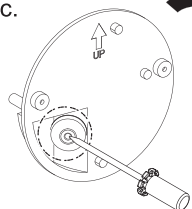

d.

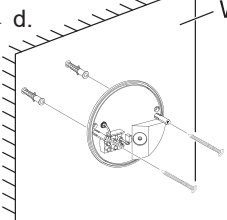

Wall

(1)

e.

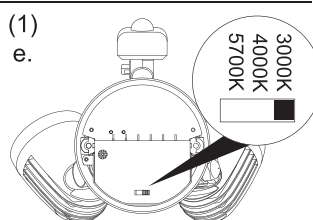

(1)

f.

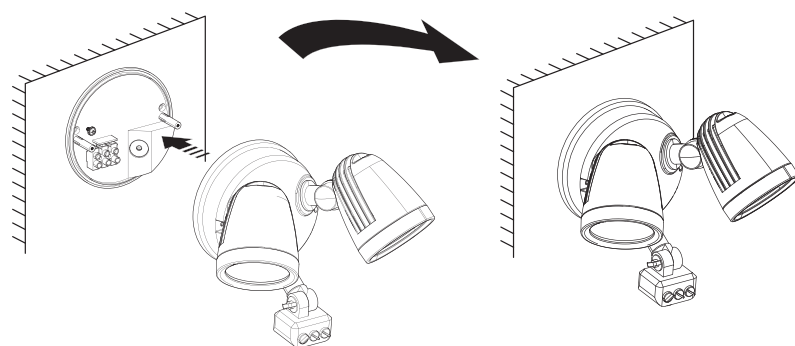

(2)

a.

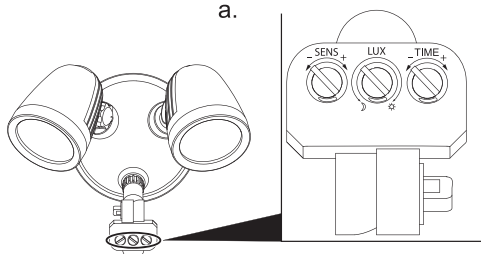

### Sensitivity Level (SENS)

Determines the detection area by increasing or decreasing the range.

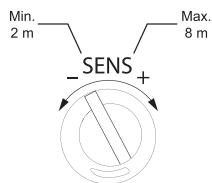

### Light Level Adjustment (LUX)

Unit can be adjusted so that the sensor only operates at or below the set ambient light level.

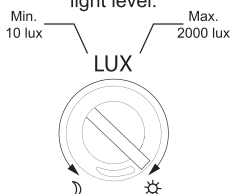

### Timer Setting (TIME)

This setting varies the time span that the spot light will remain ON after it is triggered.

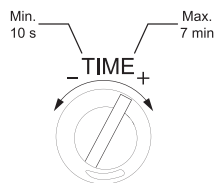

(2)

b.

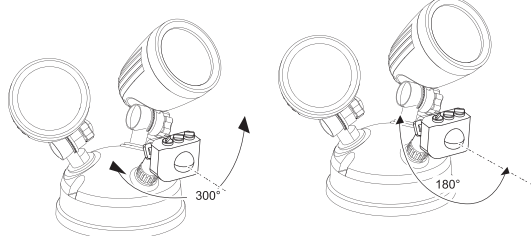

(2)

c.

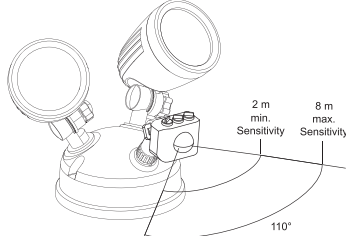

- c. Pierce through the rubber behind the backplate before the wiring installation. Mount the backplate on the wall using the wall plug and the screws
- d. Install the wires according to the wiring diagram shown in the illustration 3.
- e. Use the switch to select the required color temperature.

**NOTE:** By default the switch is set to 3000K color temperature.

- f. Mount the spot light housing to the wall using the wall plug and the screws.

### (2) Sensor adjustment procedure

- a. When the power is on, the unit will be able to detect movement within the adjustable sensor range. There are 3 adjustment settings on the top of the sensor unit for Light Level Adjustment (LUX), Timer Setting (TIME), and Sensitivity Level (SENS).

- b. Sensor alignment
- c. Sensor detection area

### (3) Commissioning procedure

#### a. MANUAL OVERRIDE FUNCTION:

- The light can stay ON for longer time periods by using the manual override function.
- Under PIR Mode, simply turn off/on/off/on the power within 3 seconds, then the unit will be in Override Mode and the light will stay ON.
- To switch back to PIR Mode, turn off the power, and 10 seconds later, turn it back on.

#### b. TEST

- To facilitate the test, set the SENS (Sensitivity) parameter to maximum, the TIME parameter to minimum, and the LUX (Illuminance) parameter to maximum.
- Power on the device. The spotlight requires at least 30 seconds for preheating of the sensing and lighting functions. In subsequent operations, the sensing period will be reduced to 10 seconds.
- Use an opaque object (such as a towel) to cover the sensor and then wave hands to trigger the light. The light will remain on for  $10 \pm 3$  seconds.

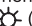
**NOTE:** when testing in daylight, please turn LUX knob to  (SUN) position, otherwise the sensor lamp could not work.

Troubleshooting

Problem: Lights turn on for no apparent reason

| Possible cause   | Possible resolution                    |
|--|--|
| Momentary power failure                                | None, unit will reset after a time-out |
| Unseen target  | Check for dogs, cats or pests          |
| Extreme draughts of hot or cold                        | None, unit will reset after a time-out |
| Tree branches or bushes moved by wind                  | None, unit will reset after a time-out |
| Vehicle or pedestrian traffic on edge of field of view | None, unit will reset after a time-out |

Problem: Light turns on during daylight

| Possible cause       | Possible resolution                        |
|----------------------|--|
| Wrong setting on LUX | Reset according to Commissioning Procedure |

Problem: Light does not turn on in dim / dark conditions

| Possible cause       | Possible resolution                        |
|----------------------|--|
| Wrong setting on LUX | Reset according to Commissioning Procedure |

Problem: Light remains permanently on

| Possible cause               | Possible resolution  |
|------------------------------|--|
| Moving source being detected | Remove unwanted source. If unable to resolve, reposition the sensor head (horizontally and vertically). The light should turn off after a time out. If the light remains on, call the Installer. |

Technical data

|                              |                                 |
|------------------------------|---------------------------------|
| Cat No.                      | TPSF                            |
| Voltage Rating               | 230 - 240Vac, 50Hz              |
| IP Rating                    | IP54                            |
| IK Rating                    | IK04                            |
| Total Power Consumption      | 2 × 15 W                        |
| Beam Angle                   | 102°                            |
| Lumen Output                 | 2 × 1200lm                      |
| Operating Temperature        | -10°C to +45°C                  |
| Operating Humidity           | 10% to 95%, RH, no condensing   |
| CRI                          | >80                             |
| Colour Temperature           | 3000K/4000K/ 5700K (Selectable) |
| Current                      | 180mA                           |
| Inrush Current               | 12A @ 20 µs                     |
| Dimension L × H × W          | 205mm × 140mm × 168mm           |
| Lifespan L70/B50 @25°C       | 35,000 hours                    |
| Material                     | Aluminium                       |
| Dimmable                     | No                              |
| Class                        | Class I                         |
| Warranty                     | 5 years                         |
| Light Level Adjustment (LUX) | 10lux Min./ 2000lux Max.        |
| Timer Setting                | 10sec Min./ 7min Max.           |
| Sensor Type                  | PIR                             |
| Sensitivity Level (SENS)     | 2m Min./ 8m Max.                |
| Sensor Detection Angle       | 110° Horizontal                 |

Warranty Information

We warrant this product for 5 years—visit

<https://www.schneider-electric.com.au/en/about-us/legal/terms-and-conditions.jsp> for details.

Our goods also come with guarantees that cannot be excluded under the Australian Consumer Law. You are entitled to a replacement or refund for a major failure and compensation for any other reasonably foreseeable loss or damage. You are also entitled to have the goods repaired or replaced if the goods fail to be of acceptable quality and the failure does not amount to a major failure.

Schneider Electric (Australia) Pty Ltd  
Customer Care: 13 73 28  
33-37 Port Wakefield Road, Gepps Cross SA 5094  
Email: [customercare.au@schneider-electric.com](mailto:customercare.au@schneider-electric.com)  
[www.schneider-electric.com.au](http://www.schneider-electric.com.au)

Schneider Electric reserves the right to change specifications, modify designs and discontinue items without incurring obligation and whilst every effort is made to ensure that descriptions, specifications and other information in this instruction is correct, no warranty is given in respect thereof and the company shall not be liable for any error therein.

© Schneider Electric 2025

This material is copyright under Australian, New Zealand and international laws. Except as permitted under the relevant law, no part of this work may be reproduced by any process without prior written permission of and acknowledgement to Schneider Electric.