



# LIFESAVER

## RF Interlink Baseplate User Guide

### Model 6000WB

Wireless RF interlink baseplate for  
LIFESAVER 6000 series Smoke Alarms.

You do NOT need a home wi-fi system  
to use these units. Multiple wireless units  
create their own independent wireless RF  
interlink network.

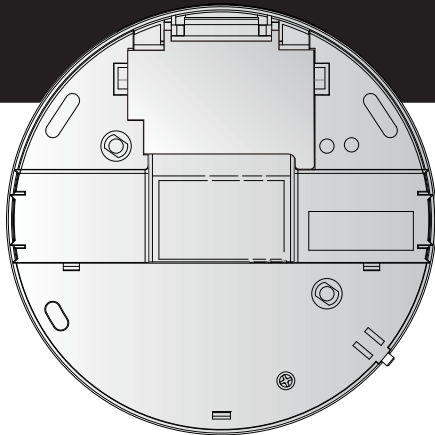

Part No: LIF6000WB



# Thank You for Choosing PSA

This LIFESAVER 6000WB base plate is capable of wirelessly interlinking other Lifesaver 6000 series mains powered smoke alarms fitted with a 6000WB wireless base and Lifesaver 6000DCW wireless smoke alarms. When one RF interlink unit sounds an alarm, all other compatible RF units in the RF interlink network will alarm.



**Read Section 2:** Activation And RF Interlink Network, before powering the units. You do NOT need a home wi-fi system to use these units. Multiple wireless units create their own independent RF interlink alarm network.

This wireless baseplate is powered by the smoke alarm. In the event of a mains power failure, the backup battery of the smoke alarm will ensure the wireless network continues to operate.

## **NOTE: A NETWORK IS LIMITED TO 24 RF DEVICES**

Teach children how to respond to the alarm and that they should never play with the unit. Your PSA LIFESAVER Smoke Alarm was designed for use in a residential environment. It is not designed for use in a recreational vehicle (RV) or boat.

**Note: Please thoroughly read this user guide and save the document for future reference and to pass on to any subsequent owner.**

**IMPORTANT: Additional markings can be found on the back of the unit.**

# Contents

1. Product Features And Specifications .....	4
2. Activation and RF Interlink Network .....	5
2.1 Setting Up an RF Interlink Network .....	5
2.2 Adding A Detector To An Existing RF Interlink Network.....	6
2.3 Resetting The 6000WB.....	7
2.4 Connecting The 6000WB RF Baseplate to 6000DCW Wireless Smoke Alarms.....	8
3. Wireless FAQs.....	9
4. Installation Instruction .....	11
5. Operation .....	14
6. Cleaning Your Alarm .....	15
7. Good Safety Habits .....	16
8. Limitations Of Smoke Alarms .....	17
9. Warranty and Liability .....	18
10. Product Warranty Registration .....	19

# 1. Product Features And Specifications

## Introduction

Installing this wireless interlink baseplate onto the PSA Lifesaver 6000 Series 240VAC smoke alarms allows the smoke alarms to be interconnected wirelessly. When one smoke alarm activates, the RF interlink will trigger other smoke alarms in the same RF network.

## Product Features and Specifications:

- Temperature: Operating Range: 0 °C to 45 °C
- Humidity: Operating range: up to 95% RH non-condensing
- Smoke Alarm Power: 240VAC 50Hz 10mA max. 4mA standby.
- Radio Module Power: 9VDC from smoke alarm
- Radio Frequency: 918MHz.
- Range: 100m line of sight. 30m indoors. Distances will vary depending on walls and obstructions.
- Design for LIFESAVER 6000 series 240VAC smoke alarms.
- Compatible with LIFESAVER 6000DCW 10 Year wireless smoke alarm.
- Connect up to 24 smoke alarms
- Approved to AS/NZS4268:2017
- Approved to AS/NZS 3786:2014 (Selected Clause)
- Approved to AS/NZS CISPR 32:2015
- Approved to AS/NZS 62368.1:2018

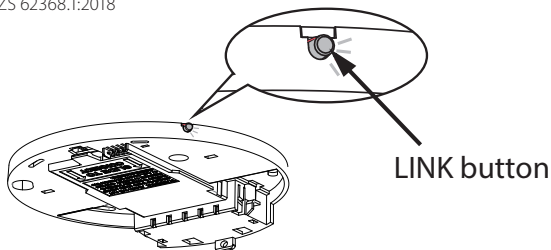

## 2. Activation and RF Interlink Network

This model is capable of interlinking with other PSA 6000WB models in domestic residential applications. When one RF interlink unit sounds an alarm, all other compatible RF units in the RF interlink network will alarm. Follow the steps in section 2.1 to interlink up to 24 units in your interlink network. If you have problems during setup, see section 2.3 to start over.

NOTE : Wireless units will emit a series of LED flashes as the unit(s) search for a RF interlink network.

### Definitions of key terminology:

**Coordinator:** The wireless network master unit that is the key communicator with the other wireless units. This assignment remains until the Coordinator is reset (section 2.3). The Coordinator unit should be installed in a central location of the residence.

**RF Device (RFD):** The other wireless units that connect to the Coordinator.

**General Reset mode:** Resets a unit to Out-of-Box condition, before it was first powered up.

## 2.1 Setting Up an RF Interlink Network

For easy first time setup, we recommend unpacking all the units together on a desk or counter. If you prefer to install the alarms on the ceiling before setting up the wireless network, then first attach all baseplates to the ceiling. Next, choose the most centrally located unit and begin with Step 2 below.

	User Action	Detector Response	Timeout
Step 1	Unpack all units and power up the smoke alarms on backup battery.		
Step 2	Connect the first smoke alarm onto the 6000WB baseplate.	6000WB powers up - Red LED flashes one second ON one second OFF. TIP: If the 6000WB does not start flashing, then press its LINK button twice quickly.	
Step 3	Press the LINK button twice on the RF Baseplate.	Two quick Red LED flashes every 2 seconds indicates the unit is configured as a Network Coordinator and Join Mode is Open	Join Mode will timeout in 15 minutes

	User Input	Detector Response	Timeout
<b>Step 4</b>	Connect each additional smoke alarm on its RF baseplate.	The Red LED of each unit will initially flash one second ON and one second OFF. After each unit joins the network, its Red LED will flash three times every 2 seconds to show it is now a RFD in the network.	Join Mode will timeout in 15 minutes after last unit joins.
<b>Step 5</b>	After all units have joined, press LINK button twice on the baseplate.	Red LED on each unit will turn off indicating Standby Mode	
<b>Step 6</b>	Follow installation instructions in section 4.		

## 2.2 Adding A Detector To An Existing RF Interlink Network

At some point, you might want to add another smoke alarm unit to your existing RF interlink network for additional protection, or to replace an old unit. Follow the steps in the following table.

	User Input	Detector Response	Timeout
<b>Step 1</b>	Press the LINK button twice on any existing 6000WB (or 6000DCW) unit.	Unit will respond with two quick flashes every 2 seconds if it is the Coordinator of the Network; three quick flashes every 2 seconds if it is a RFD in the Network - Join Mode is open.	Join Mode will timeout in 15 minutes
<b>Step 2</b>	Power up unit(s) to be added - by mounting the smoke alarm onto the RF baseplate. For previous units that have been reset, press the LINK button twice to enter Join Mode.	Red LED flashes three times every 2 seconds to indicate it is configured (as a RFD) in the network	Join Mode will timeout in 15 minutes
<b>Step 3</b>	After new unit(s) have joined, press LINK button twice on any unit in the network to close Join Mode.	Red LED on each unit will power off indicating Standby Mode	Join Mode will timeout in 15 minutes
<b>Step 4</b>	Follow installation instructions in Section 4.		

## 2.3 Resetting The 6000WB

This section explains how to perform a general reset on a 6000WB unit. This restores the unit to when it was first powered up. This procedure can also remove a 6000WB from a network.

Follow the steps below to resolve any of these situations:

- \* If you have problems connecting the 6000WB to a wireless network. Or if the network configuration has become confused.
- \* If a 6000WB is consistently out of range, and needs to be removed from the wireless network.
- \* If you decide to transfer a 6000WB from your network to another wireless network (eg. at your friend's or family's place).

	User Input	Detector Response	Timeout
<b>Step 1</b>	Press the LINK button twice on any existing 6000WB (or 6000DCW) unit.	The unit will enter Join Mode and flash its Red LED either: (1) Twice every 2 seconds - denotes Coordinator (2) Three times every 2 seconds - denotes RFD OR (3) 1 second ON, then 1 second OFF - denotes Network Search.	
<b>Step 2</b>	Press and hold its LINK button to reset the 6000WB unit.	The Red LED will blink four times, which is repeated, to indicate the unit has been reset. It is now in standalone mode, and will not be part of any network until its LINK button is pressed twice to re-enter Join Mode.	
<b>Step 3</b>	Press the LINK button twice on any other wireless unit to close the Join Mode.	Red LED on each unit will power off indicating Standby Mode	
<b>Step 4</b>	To re-join a network, please start over with Section 2.2 If any issues occur, please call PSA Technical Support.		

## 2.4 Connecting The 6000WB RF Baseplate to 6000DCW Wireless Smoke Alarms

This section explains how to setup the mains powered smoke alarm with the RF baseplate to wirelessly connect with LIFESAVER model 6000DCW RF interlink smoke alarms. The joining process is similar to previous steps. It is recommended for the 6000DCW Wireless smoke alarm to be configured as the Coordinator unit.

	User Input	Detector Response	Timeout
<b>Step 1</b>	Power the smoke alarm on battery and connect on to the 6000WB baseplate.	6000WB powers up - Red LED flashes one second ON one second OFF.	
<b>Step 2</b>	Press the LINK button twice on the RF Baseplate.	Two quick Red LED flashes every 2 seconds indicates unit is configured as a Network Coordinator and Join Mode is Open. Three red LED flashes indicates the unit is a network RFD and Join Mode is Open.	Join Mode will timeout in 15 minutes.
<b>Step 3</b>	Power up the new 6000DCW smoke alarms by twisting them onto their mounting bases.	Red LED on each 6000DCW unit will initially flash one second ON and one second OFF. After each unit has joined the network, its Red LED will flash three times every 2 seconds to indicate it has been configured as a network RFD.	Join Mode will timeout in 15 minutes after last unit joins.
<b>Step 4</b>	After all units have joined, press LINK button twice on the baseplate.	Red LED on each unit will power off indicating Standby Mode.	
<b>Step 5</b>	Follow installation instructions in section 4.		



### 3. Wireless FAQs

ID	FAQ	Answer
1	<i>Can the wireless units be connected together (on the bench) before installing them?</i>	Yes, the 6000WB and any 6000DCW smoke alarms can be paired together before installing them onto the ceiling. See Section 2.1 for details.
2	<i>What happens if units are powered up for the first time but no buttons are pressed?</i>	Units will search for a network for 15 minutes after which all units will go into Standby and the LEDs will be turned off.  To retry, press the LINK button twice quickly to re-enter Join Mode. See Section 2.1 for details.
3	<i>What happens if a RFD doesn't find a network during the joining process (eg. due to defective radio link, being out of range, or couldn't find a Coordinator)</i>	Unit will go into standby and LED will flash every 2 seconds indicating Network not found. The unit will then become a stand alone smoke alarm with no interlink.
4	<i>What happens if a Coordinator doesn't find any RFD to join after being set as Coordinator.</i>	Coordinator times out after 15 min, becomes a stand alone smoke alarm with no interlink.  RFD times out after 15 minutes, becomes a stand alone smoke alarm. Red LED will flash every 2 seconds indicating that they are not joined.
5	<i>What happens if an RFD drops from the network?</i>	The RFD will enter fault mode after approximately 30min.
6	<i>What happens if an RFD drops from the network and comes back online?</i>	Nothing within ~30min.  After 30 minutes it will go into error mode - network fault. Once the RFD comes back online, pressing the LINK button twice on any unit in the network will allow it to re-join.
7	<i>What happens if the Coordinator drops from the network?</i>	<b>IF</b> no other units can hear the Coordinator <b>AND</b> RFD1 can hear all the others: RFD unit 1 becomes the coordinator after 30 min and other RFD's will re-join.

# Wireless FAQs

ID	FAQ	Answer
8	<b><i>What happens if the coordinator drops from the network and comes back online?.</i></b>	Nothing within 30min. After 30 min, push LINK button twice, and then push/hold LINK button for approx 4 seconds. Unit is reset. Push LINK button twice to reopen network and rejoin. See section 2.3. (assuming RFD1 unit 1 took over). The ex-Coordinator unit can be joined to the network as RFD unit, network issue clears.
9	<b><i>How can a unit be added to the network?</i></b>	Push LINK button twice on any existing networked unit. Power on new unit and wait for it to join. Push any LINK button twice to close network. See Section 2.2.
10	<b><i>Can the joining process be reset/restarted?</i></b>	Yes. Push LINK button twice to open network. Press & hold the LINK button until it flashes four times. Press the LINK button twice to re-open its wireless network. See Section 2.3 for details.
11	<b><i>Is there a way to get more information about a trouble status?</i></b>	In fault mode press LINK button for red LED error code. Count the number of Red LED flashes and report to customer support.
12	<b><i>What happens if the user created more than one Coordinator?</i></b>	Only one Coordinator is allowed per network. See Section 2.3 to reset the extra Coordinator; for reconnection as a RFD unit..
13	<b><i>How do I check the number of wireless units in the network?</i></b>	While in Join mode, press and release LINK button on any joined unit. LED will blink out number of units.
14	<b><i>Is it possible to check if a unit is the Coordinator or a RFD?</i></b>	Press the LINK button twice quickly to place the unit into Join Mode. If the unit flashes twice every two seconds, it is a Coordinator. And if it flashes three times every two seconds, it is a RFD device.
15	<b><i>If the mains power to the smoke alarm is turned off, will the RF baseplate remain on?</i></b>	Yes, the RF wireless baseplate will remain on as it is powered by the smoke alarm backup battery.

## 4. Installation Instruction

It is recommended to connect alarms and bases to a dedicated circuit that is separately electrically protected. This helps minimise interference (EMI) on alarm interconnect line from CFL's, dimmers, LV transformers etc.

- This wireless base will not detect smoke or heat and must be installed in conjunction with the specified alarms. Only connect to the specified models of smoke or heat alarm. Do not connect to any other brand of alarm/auxiliary device unless approved by PSA.
- The earth terminal connection provided is for termination purposes only and is NOT electrically connected within the sealed alarm / base units.

** WARNING: THIS Wireless base MUST BE INSTALLED BY QUALIFIED (LICENSED) ELECTRICIANS ONLY.**

### **Wiring Instructions:**

- In the interests of safety, this wireless base and all wiring must be installed by a licensed electrician in accordance with the relevant requirements of the SAA Wiring Rules - AS3000.
- This wireless base plate can only interconnect with compatible smoke alarms. Interconnection with other brands may cause damage, result in electric shock, fire risk and void warranty.

- There are five terminals in the supply terminal block, marked 9V, A, SW, N and LOOP. It is important that the alarm be wired correctly to ensure correct operation. Incorrect wiring to the Smoke Alarm will damage the unit and void the warranty.
- Terminals on the back of base plate are marked and coloured as follows:

#### MARKINGS

9V	9VDC POSITIVE POWER SOURCE
A	ACTIVE
SW	SWITCH WIRE (FOR INTERCONNECTION ONLY)
N	NEUTRAL
LOOP	DEAD TERMINAL

**⚠ WARNING:** Connecting the Switch wire terminal to any other supply conductor may result in damage to the alarm, failure to operate or shock hazard and void the warranty of the alarm.

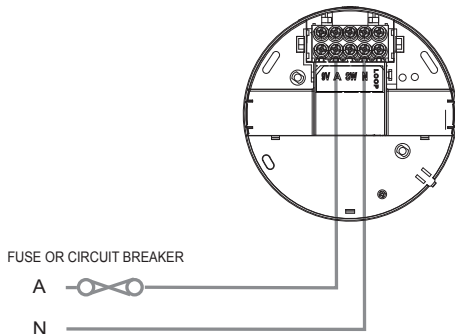

To connect all wireless bases use only the Active and Neutral lines. Do not connect to the SW terminal. See diagram below.

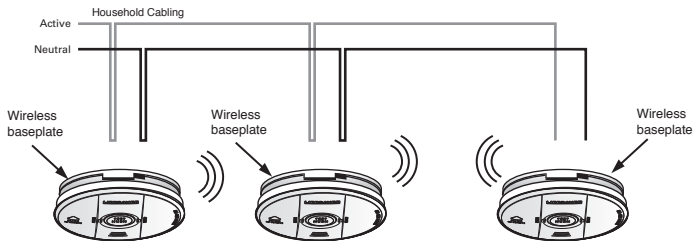

To expand an existing interconnected system, connect a wireless base to one alarm of the hardwired system and then install an additional wireless base at each new location. **DO NOT HARDWIRE THE SW TERMINAL OF TWO ALARMS WITH WIRELESS BASE TOGETHER.**

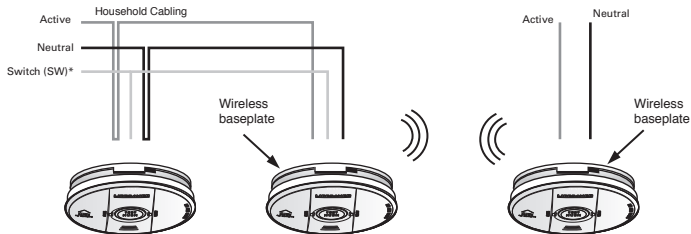

**NOTE:** Smoke alarms can be replaced without replacing the wireless base.

## 5. Operation

**OPERATION:** The smoke alarm is operational, once it is connected onto the 6000WB base, which had been successfully configured into the wireless network (See Section 2). When products of combustion are sensed, the unit sounds a loud 85db pulsating alarm until the air is cleared. If the cause of the alarm is unknown, you should assume it was triggered by a real fire, and evacuate immediately.

**TESTING:** To test the smoke alarm, press its TEST button. If the unit is interlinked to other devices in the network, all other alarms will sound. A short delay may happen before the alarms activate. Pushing the button will sound the alarm if the electronic circuitry, horn, and battery are working. If no alarm sounds, the unit has a defective battery or other failure, and should be replaced with a new alarm. If RF interlinked to other wireless smoke alarms in the same network, all smoke alarms will sound. It may take a few seconds for other interlinked units to alarm.

**⚠ WARNING: DO NOT USE AN OPEN FLAME TO TEST YOUR ALARM, YOU COULD DAMAGE THE ALARM OR IGNITE COMBUSTIBLE MATERIALS AND START A FIRE ACCIDENTALLY. USE SMOKE TESTER LIFLT711 TO EFFECTIVELY TEST THE OPTICAL CHAMBER.**

**NOTE: MONTHLY TESTING IS RECOMMENDED.**

**HUSH & LOCATE FUNCTIONS:** If smoke alarms are interlinked in a network, when one smoke alarm activates (initiating unit), other units will also activate. For interlinked network of smoke alarms with 6000WB only, pressing the HUSH button on the initiating smoke alarm will hush all the smoke alarms in the network.

If LIFESAVER 6000DCW smoke alarms are interlinked in the same network, pressing the HUSH button on any non-initiating 6000DCW smoke alarm will silence all smoke alarms EXCEPT for the initiating smoke alarm for 2 minutes. The **LOCATE** feature can be used repeatedly to find the initiating alarm or until the smoke has cleared.

Lifesaver 6000 series smoke alarms are compatible with the Lifesaver 6000THL Smoke Alarm Remote Control to conveniently test, locate and hush your smoke alarm system.

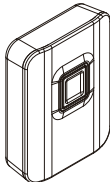

## 6. Cleaning Your Alarm

### **YOUR ALARM SHOULD BE CLEANED AT LEAST ONCE A YEAR.**

You can clean the interior of your alarm (sensing chamber) by using compressed air or a vacuum cleaner hose to blow or vacuum through the openings around the perimeter of the alarm. The outside of the alarm can be wiped with a damp cloth.

After cleaning, reinstall your alarm and test your alarm by pressing the Test Button. If cleaning does not restore the alarm to normal operation the alarm should be replaced.

**⚠ WARNING : Reinstall the Alarm as soon as possible to ensure continuous protection.**

Please note: False alarms triggered by contaminants such as dust and insects inside the smoke alarm will not be covered under warranty. Please ensure the smoke alarms are properly maintained and cleaned regularly.

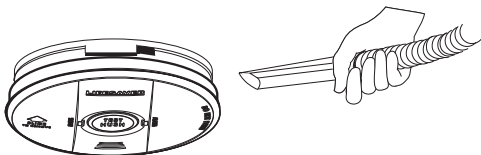

## 7. Good Safety Habits

### DEVELOP AND PRACTICE AN ESCAPE PLAN

- Install and maintain Fire extinguishers on every level of the home, in the kitchen, basement and garage. Know how to use a fire extinguisher prior to an emergency.
- Make a floor plan indicating all doors and windows and at least two (2) escape routes from each room. Second story windows may need a rope or chain ladder.
- Have a family meeting and discuss your escape plan, showing everyone what to do in case of fire.
- Determine a place outside your home where you all can meet if a fire occurs.
- Familiarise everyone with the sound of the smoke alarm and train them to leave your home when they hear it.
- Practice a fire drill at least every six months, including fire drills at night. Ensure that small children hear the alarm and wake when it sounds. They must wake up in order to execute the escape plan. Practice allows all occupants to test your plan before an emergency. You may not be able to reach your children. It is important they know what to do.

### RECOMMENDATIONS

#### Do I Need More Smoke Alarms?

The required number of smoke alarms might not provide reliable warning for areas separated by a door from the protected areas with smoke alarms.

For this reason, we recommend installing additional smoke alarms for increased protection. These additional unprotected areas include the basement, bedrooms, dining room, utility room, and hallways.

It is not recommended for smoke alarms to be installed in the kitchen, attic or garage; as these locations can experience conditions that would result in improper operation..



## 8. Limitations Of Smoke Alarms

### **WARNING: PLEASE READ CAREFULLY AND THOROUGHLY.**

- Fire safety in residential occupancies is primarily based on providing early warning to the occupants of the need to evacuate the building. This must be followed by their appropriate actions. Fire warning systems for dwelling units are capable of protecting about half of the occupants in potentially fatal fires. Victims are often either trapped by the fire, too old or young, physically or mentally impaired, such that they cannot escape even when early warning was given. For these people, other strategies such as assisted escape or rescue are necessary.
- Smoke alarms must be tested regularly to ensure the batteries and the alarm circuits are in good operating condition.
- Smoke alarms cannot provide an alarm if smoke does not reach the alarm. Therefore, smoke alarms may not sense fires that have started in chimneys, walls, on roofs, on the other side of a closed door or on a different floor.
- If the alarm is located outside the bedroom or on a different floor, it may not wake up a sound sleeper.
- The use of alcohol or drugs may also impair one's ability to hear the smoke alarm. For maximum protection, a smoke alarm should be installed in each sleeping area on every level of a home.
- Although smoke alarms can help save lives by providing an early warning of a fire, they are not a substitute for an insurance policy. Home owners and renters should have adequate insurance to protect their lives and property.

## 9. Warranty and Liability

1. PSA Products Pty Ltd (ABN: 99 076 468 703) of 17 Millicent Street, Burwood 3125 Victoria, Australia warrants this product for a period of five (5) years from the date of purchase, as reflected on the Authorised Reseller's or Distributor' invoice / receipt provided to you. PSA Products Pty Ltd will repair or replace the product (at the option of PSA Products) due to any manufacturing defect, at the cost of PSA Products Pty Ltd (excluding any labour costs relating to removal or re-installation of product, and transport costs).
2. This warranty shall not apply to the product if it has been damaged, modified, abused or altered after the date of purchase, or if it fails to operate due to improper maintenance.
3. To the extent permitted by law, the liability of PSA Products Pty Ltd arising from the sale or under the terms of this limited warranty shall not in any case exceed the cost of replacement and subject to this clause. In no case shall PSA Products Pty Ltd be liable for consequential loss or damages resulting from the failure of the product or breach of this, or: Any other warranty, express or implied, loss or damage caused by failure to abide by the instructions supplied in the leaflets.
4. To the extent permitted by law, PSA Products Pty Ltd., makes no warranty, expressed or implied, written or oral, including that of merchantability or fitness for any particular purpose, with respect to the consumer replaceable battery if any. A product with non-serviceable built-in battery is covered under warranty of the product.
5. This warranty is provided in addition to other rights and remedies you have under law: Our goods come with guarantees that cannot be excluded under the Australian Consumer Law. You are entitled to a replacement or refund for a major failure and compensation for any other reasonably foreseeable loss or damage. You are also entitled to have the goods repaired or replaced if the goods fail to be of acceptable quality and the failure does not amount to a major failure. What constitutes a major failure is set out in the Australian Consumer Law.
6. To make a claim under warranty, take the product (with a proof of purchase) to the store where you purchased the product or contact PSA Products Pty Ltd. Phone (03) 9888 9889. or Email: [enquiry@psaproducts.com.au](mailto:enquiry@psaproducts.com.au) with details, proof of purchase or expense claim in writing.

## 10. Product Warranty Registration

Thank you for purchasing and installing the most trusted brand in fire, security and intercoms. To ensure you receive excellent after-sale product service we encourage you to register your products. There are a few important reasons to register your product:

1. It will ensure your investment is protected in case it is damaged or broken and we can effectively carry out any warranty claims.
2. Registration will also allow us to contact you in an unlikely event of product safety notification required under Consumer Product Safety Act.
3. Registration will also help us improve our product design to meet your needs.

Register at: <https://www.psaproducts.com.au/register-product/>

Register this product for warranty to ensure fast and effective service.

Otherwise, please retain this warranty section and complete the details below. When you claim Warranty for the product please present this section together with the faulty product.

Model: \_\_\_\_\_ Serial Number: \_\_\_\_\_

Date Of Purchase/ Installation: \_\_\_\_\_ Invoice No: \_\_\_\_\_

Installed By: \_\_\_\_\_

Owner's Details: \_\_\_\_\_

**Smoke alarm has an expected service life of 10 years under normal conditions. We recommend that you should replace the smoke alarm after 10 years from installation date to ensure normal operation.**

DEAR INSTALLER:  
PLEASE LEAVE THIS MANUAL FOR THE OWNER.  
THANK YOU FOR CHOOSING THIS SMOKE ALARM.



Tested & Complies to  
Australian Standards  
AS3786:2014



*Manufactured under ISO standard  
Quality Approved Manufacturing*



*Another Quality Product By:*

**PSA Products Pty Ltd**

17 Millicent Street, Burwood, Victoria 3125, Australia

Ph: (03) 9888 9889

Email: [enquiry@psaproducts.com.au](mailto:enquiry@psaproducts.com.au)

Website: [www.psaproducts.com.au](http://www.psaproducts.com.au)